

# TSF

## Truss Spacer

The TSF is a fast and accurate method for spacing trusses that eliminates layout marking of top plates and can be left in place under the sheathing. Accuracy is improved, spacing errors are minimized, and it is easy to use.

**Material:** 22 gauge

**Finish:** Galvanized

**Installation:**

- See installation sequence below.
- TSF truss spacers do not provide bracing of any kind and are not structural members. The TSF is for spacing only. Refer to instructions from architect, engineer, truss manufacturer or other for bracing and installation information.

**Codes:** See p. 11 for Code Reference Key Chart

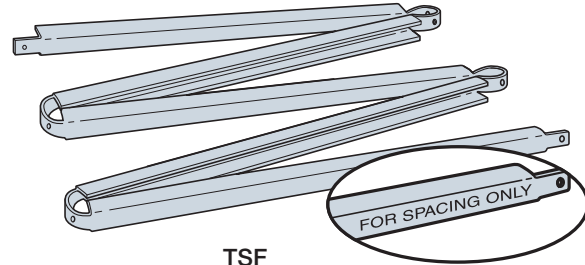

TSF

| Model No. | Dimensions |              |              | Code Ref. |
|-----------|------------|--------------|--------------|-----------|
|           | W          | O.C. Spacing | Total Length |           |
| TSF2-16   | 1 ½"       | 16"          | 8'           | —         |
| TSF2-24   | 1 ½"       | 24"          | 10'          |           |

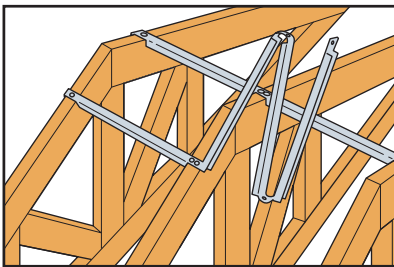

**Step 1**

Nail starting notch to first member.

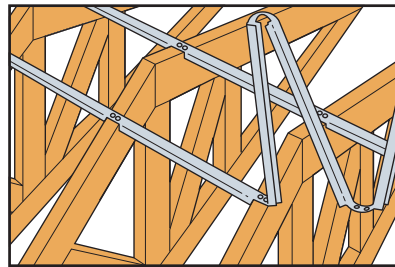

**Step 2**

As each successive member is positioned, unfold TSF to next notch. The notch teeth grip member and align it for nailing.

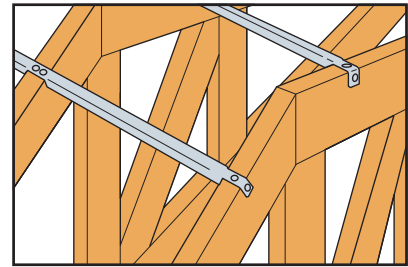

**Step 3**

If spacer does not align with end truss, break spacer off at notch. Then, hammer spacer flat, fold it under and nail.