

# PS/PSQ/HST

## Strap Ties

PS/PSQ pile straps are ideal for attaching girders to piles, bringing strength to the connection when the wood members are notched. The PSQ installs faster and easier with the patented Strong-Drive® SDWH Timber-Hex HDG screws and offers higher loads. (Screws not included.)

**Finish:** PS/PSQ — HDG; also available in black powder coat (add PC to sku); contact Simpson Strong-Tie.  
HST2 and HST5 — Galvanized  
HST3 and HST6 — Simpson Strong-Tie gray paint

**Material:** See table

**Codes:** See p. 11 for Code Reference Key Chart

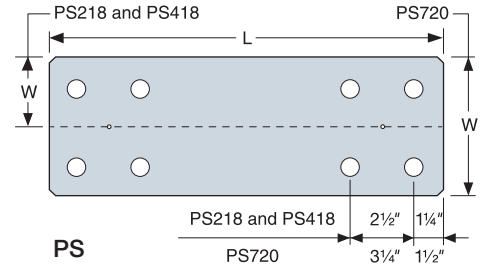

These products are available with additional corrosion protection. For more information, see p. 14.

Model No.	Ga.	Dimensions (in.)		Fasteners (Total)	Allowable Tension Loads (DF/SP)	Allowable Tension Loads (SPF/HF)	Code Ref.
		W	L		(160)	(160)	
PS218	7	2	18	(4) 3/4" MB	1,740	1,385	—
PS418		4	18	(4) 3/4" MB	1,740	1,385	
PS720		6 3/4	20	(8) 1/2" MB	3,075	2,645	
PSQ218		2	18	(8) SDWH27400G	2,815	2,420	
PSQ418		4	18	(8) SDWH27400G	3,045	2,620	

- See pp. 266–267 for Straps and Ties General Notes.
- Posts and beams may consist of multiple members provided they are connected independently of the strap fasteners.
- PSQ loads are per part (not pair). F<sub>1</sub> loads on DF/SP for PSQ218 and PSQ418 are 750 lb. and 780 lb., respectively. SPF/HF F<sub>1</sub> loads are 645 lb. and 670 lb.
- PS loads are per part (not pair). Loads are based on perpendicular-to-grain loading in the beam and parallel-to-grain loading in the post and assume a minimum member thickness of 3 1/2". PS straps must be positioned such that bolt end and edge distances meet NDS minimum requirements.
- Screws:** SDWH27400G = 0.27"-diameter x 4"-long Strong-Drive SDWH Timber-Hex HDG screw. (Longer SDWH27G screws may be used.)

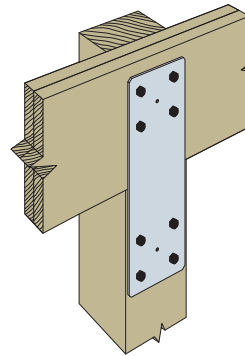
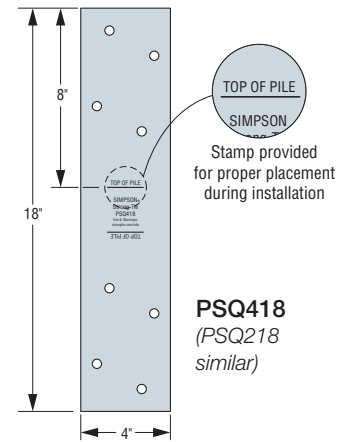

Typical PS720 Installation

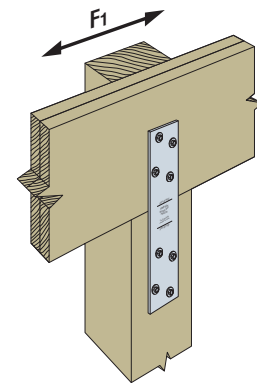

Typical PSQ Installation

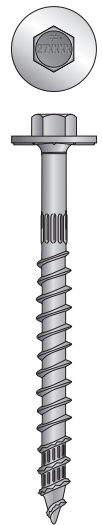

SDWH27400G

Model No.	Ga.	Dimensions (in.)		Fasteners (in.)		Allowable Tension Loads (DF/SP)	Allowable Tension Loads (SPF/HF)	Code Ref.	
		W	L	Nails	Bolts				
					Qty.				Dia.
HST2	7	2 1/2	21 1/4	—	6	5/8	5,220	IBC, FL, LA	
HST5		5	21 1/4	—	12	5/8	10,650		
HST3	3	3	25 1/2	—	6	3/4	7,650		
HST6		6	25 1/2	—	12	3/4	15,425		

- See pp. 266–267 for Straps and Ties General Notes.
- Allowable bolt loads are based on parallel-to-grain loading and these minimum member thicknesses: HST2 and HST5 – 3 1/2"; HST3 and HST6 – 4 1/2".

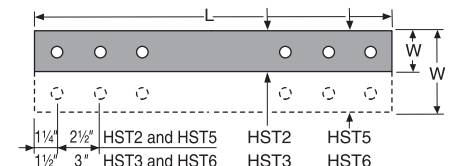

HST